

INSITE is a pioneer in the field of Space and Asset Management.

For more than 40 years, INSITE Space Management and Asset Management solutions have been used by some of the most prestigious institutions around the world to manage, plan and report on space and assets. Whether your institution is large or small, INSITE has a solution to meet your needs.

With INSITE, quickly find, access, and analyze data using one uniform interface. Groups are no longer interdependent upon one another for reports and analysis. And, best of all, results are almost instantaneous. Your data appears as lists or easy to understand graphic floor plans on your PC within seconds.

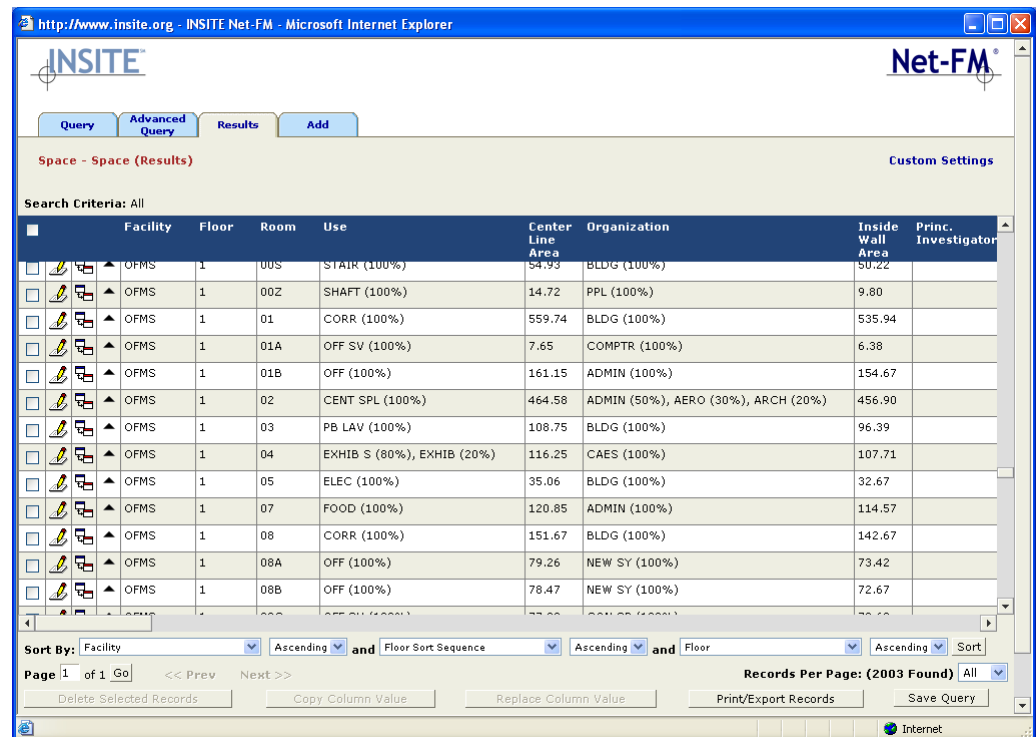

The screenshot shows the INSITE Net-FM web application interface. At the top, there are navigation tabs for 'Query', 'Advanced Query', 'Results', and 'Add'. Below these is a search bar and a 'Custom Settings' link. The main content area displays a table titled 'Space - Space (Results)'. The table has columns for Facility, Floor, Room, Use, Center Line Area, Organization, Inside Wall Area, and Princ. Investigator. The table contains 15 rows of data, each representing a different room or space within a facility. Below the table, there are sorting options (Sort By, Ascending, Descending) and pagination controls (Page 1 of 1, Records Per Page: 2003 Found).

Facility	Floor	Room	Use	Center Line Area	Organization	Inside Wall Area	Princ. Investigator
OFMS	1	00S	STAIR (100%)	54.93	BLDG (100%)	50.22	
OFMS	1	00Z	SHAFT (100%)	14.72	PPL (100%)	9.80	
OFMS	1	01	CORR (100%)	559.74	BLDG (100%)	535.94	
OFMS	1	01A	OFF SV (100%)	7.65	COMPTR (100%)	6.38	
OFMS	1	01B	OFF (100%)	161.15	ADMIN (100%)	154.67	
OFMS	1	02	CENT SPL (100%)	464.58	ADMIN (50%), AERO (30%), ARCH (20%)	456.90	
OFMS	1	03	PB LAV (100%)	108.75	BLDG (100%)	96.39	
OFMS	1	04	EXHIB S (80%), EXHIB (20%)	116.25	CAES (100%)	107.71	
OFMS	1	05	ELEC (100%)	35.06	BLDG (100%)	32.67	
OFMS	1	07	FOOD (100%)	120.85	ADMIN (100%)	114.57	
OFMS	1	08	CORR (100%)	151.67	BLDG (100%)	142.67	
OFMS	1	08A	OFF (100%)	79.26	NEW SY (100%)	73.42	
OFMS	1	08B	OFF (100%)	78.47	NEW SY (100%)	72.67	

Benefits

- Submit queries to cross-reference, verify, and analyze data.
- Simply point and click to explore the logically organized results.
- Uncover otherwise difficult to see relationships.
- Quickly uncover more details about your system than you thought possible.
- Find relationships that you didn't even know you had.

INSITE Space Management is a comprehensive software application for managing the physical spaces within buildings and other structures. Originally developed by a first-class university to deal with the specific requirements of colleges and universities, INSITE provides an institution wide view of managed space and provides a central depository for space inventory to track all attributes, including occupants, within your facilities. INSITE provides you the means to effectively manage the use of space by maintaining an accurate inventory of space and assigning that space within your institution by individual room numbers, occupying organizations, architectural room uses, configurations and areas. A host of additional space related data can be tracked. The entire database is organized in a hierarchy, from spaces to floors to buildings to sites to regions. The application allows complete freedom to devise, test and apply space utilization standards via ratio analysis. Space Management also provides the ability to support space planning scenarios for space and occupant allocation studies.

Benefits

Some of the Space Management capabilities and benefits include:

- User defined attributes
- Standard reports
- International units of measure
- Both BOMA and FICM area measurements
- Track non-building entities
- Track gross, assignable and non-assignable areas
- Track capacity and cost of space
- Track use, organization, and people within each space
- Classify space by user defined standards
- Manage assignment by organization or functional use
- Accommodate multiple organizations and uses
- Allocate space by percentage of use
- Calculate charge back costs based on organization, use or personnel
- Track equipment assigned to spaces

Standard Features

INSITE includes many standard features, including:

- User, application, and form security levels
- Configurable menus and forms for individual users
- User defined attributes
- Standard reports
- User ad-hoc query and reporting
- Color cues for required field input
- Flexible attribute fields
- Audit trail on records showing date, user, and values changed

Locations / Floors / Spaces

INSITE provides for a location hierarchy:

- Capture region, site, facility, floor, and space in location hierarchy
- Capture relationships between facilities and other entities such as grounds, fields, parking lots and other structures
- Track space by FICM classification as well as user defined codes
- Attach CAD drawings and other electronic files to locations
- Report on area of spaces by space, floor, facility, site and region
- Report on assignable and non-assignable areas

Organization/Department

- Capture a full hierarchical organizational structure; organizations or companies, divisions, and departments
- Assign employees/staff to organizational structure
- Track occupants, organizations, uses, and equipment in each space
- Track occupancy by organization
- Accommodate multiple organizations within each space
- Allocate space to organizations by percentage of use

Space Allocation, Planning, and Management

INSITE provides complete management of space use and occupancy

- Assign space to multiple organizations within multiple locations
- Assign occupants to multiple locations
- Designate space for research (and cost recovery or charge back)
- Assign use and multiple uses of space
- Search for vacant space
- Report on space cost based on utilization
- Track lease and ownership status
- Make consolidation and expansion decisions
- Analyze availability of space to minimize facility costs
- Calculate occupancy costs per area
- Prepare occupancy plans, average area per occupant, and occupant rosters

Link to Drawings

Space Management also provides graphic information management using INSITE Visual-FM™, View-FM™ and INSITE ACADLink™. All of these have a direct interface with the INSITE space database.

- Create alternative move scenarios
- Link occupant, space, and equipment data to the database without embedding data into the drawings
- Update the database from within the drawing
- Update embedded drawing data from within the database
- Audit and reconcile calculated areas in drawings to the areas in the database
- Generate colored and hatched thematic plans based on user-defined queries

Floor Plan Queries

INSITE has developed a unique link between INSITE's floor plan applications and the INSITE database. Powerful query capabilities allow users to find the information they need in a quick and meaningful way. Features include:

- Access to multiple database tables
- Queries based on complex criteria
- User-defined preparation of graphical presentation including colors, hatching, and text
- Graphic reports on the location of all spaces occupied by organization, use, and other space and occupancy data
- Customizable report legends

Visual Space Planning

INSITE's View-FM™ floor plan application is designed specifically for non-CAD users who need access to information and do not have authority to change drawings. View-FM is a view only application that allows user to query drawings, and the database, for the information they need as well as to “redline” drawings for planning purposes. This feature allows users to create “what-if” scenarios with drawings without changing the drawing of record. Occupants, spaces, and organizations can be rearranged for a proposal or presentation.

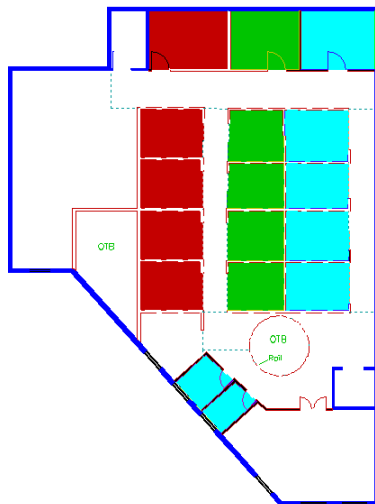

View-FM Floor Plan Scenario

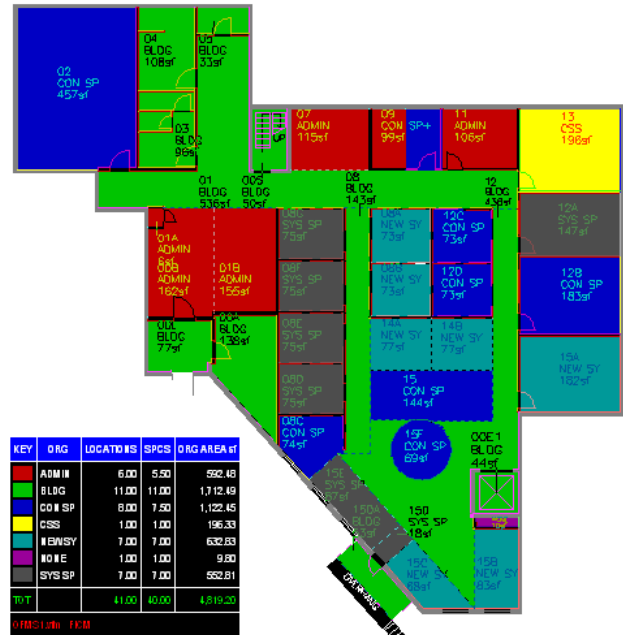

Visual-FM Floor Plan Query Report

Please contact us for more information.



US Headquarters

INSITE
100 Corporate Place
Peabody, MA 01960
USA
ph: 978-536-0129

UK Office

INSITE
293 Apperley Road
Apperley Bridge, Bradford
BD10 0PX, UK
ph: +44-127-461-4421

email: sales@insite.org

url: www.insite.org